



SOUL ESTATES

SALES & LETTINGS

TO LET - 2 BEDROOM GROUND FLOOR APARTMENT

Ferguson Drive, Tipton, DY4 7NS

£825 PCM

Soul Estates are proud to present this well presented 2 bedroom ground floor apartment To Let. This apartment is situated in a very popular area of Tipton. Situated near Tipton Leisure Centre with good schools, local amenities, and transport links and close to Q3 Academy in Tipton and Great Bridge.

The property offers an entrance hallway with rooms going off to two bedrooms, spacious lounge, fitted kitchen, and family bathroom. Kitchen with a range of wall and base units to match, splashback tiling with an electric hob and oven. The property also benefits double glazing and off-road parking.

✓ **2 BEDROOM GROUND FLOOR APARTMENT**

✓ **ALLOCATED PARKING**

✓ **SPACIOUS LOUNGE**

✓ **FURNISHED OPTION ALSO AVAILABLE**







SOUL ESTATES

SALES & LETTINGS

TO LET - 2 BEDROOM GROUND FLOOR APARTMENT

Ferguson Drive, Tipton, DY4 7NS

£825 PCM

Ground Floor

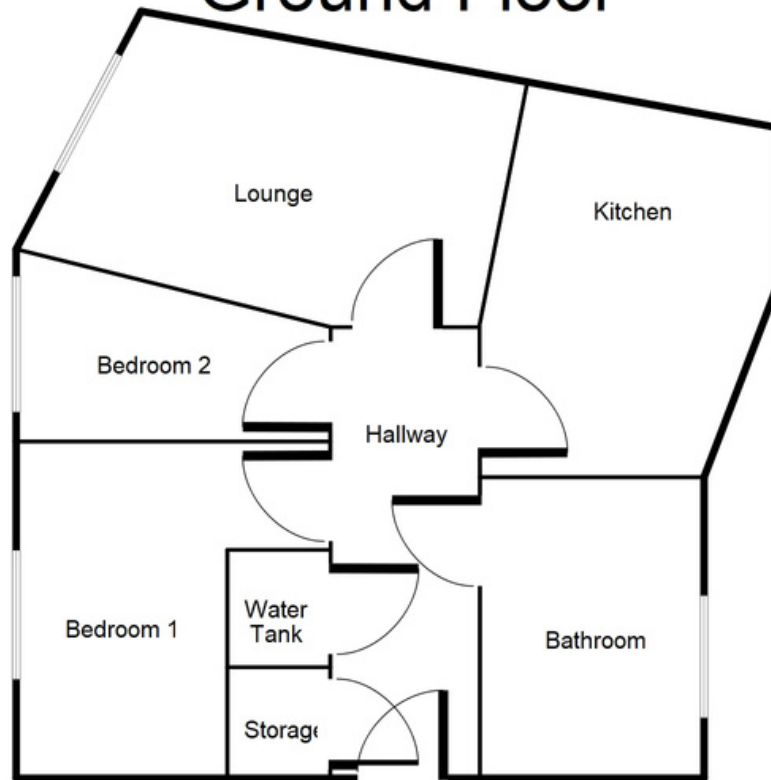

This floorplan is just an example, this is not to scale.
Please see description for exact room sizes.
(c) Soul Estates

Entrance Hallway

13' 3" x 3' 3" (4.04m x 0.99m)

Kitchen

11' 9" x 8' 6" (3.58m x 2.59m)

Lounge

12' 11" x 14' 0" (3.93m x 4.26m)

Bedroom 1

8' 10" x 12' 6" (2.69m x 3.81m)

Bedroom 2

11' 3" x 12' 7" (3.43m x 3.83m)

Bathroom

7' 1" x 6' 4" (2.16m x 1.93m)